

**AL-KO**  
QUALITY FOR LIFE

# HIGH-TECH COMPONENTS FOR MOTORHOMES





	Page
Overview of AL-KO CHASSIS components .....	6
<b>AL-KO CHASSIS .....</b>	<b>10–15</b>
AL-KO CHASSIS (comfort and safety).....	12
AL-KO CHASSIS (lightweight construction and flexibility).....	13
2- and 3-axle technology .....	14
Motorhome manufacturers with AL-KO CHASSIS.....	15
<b>Chassis components.....</b>	<b>16–27</b>
AL-KO Comfort Suspension (ACS) .....	18
Torsion bar suspension.....	20
AL-KO Level Controller (ALC).....	21
Air Premium X4 full air suspension.....	22
Air Premium X2 full air suspension.....	24
Air Plus / Air Top additional air suspension systems .....	25
Chassis advisor.....	26
<b>Comfort accessories .....</b>	<b>28–33</b>
HY4.....	30
ClickFix steady leg .....	32
Arex Light II steady leg.....	32
Towbars.....	33
<b>Carrier systems.....</b>	<b>34–41</b>
Velo III.....	36
Mikro II .....	36
Vario .....	37
Ligero III.....	38
Backpack 150.....	39
Trineo.....	40
Wheely .....	41
<b>Technical data and prices.....</b>	<b>42–51</b>

# AL-KO

## QUALITY FOR LIFE



### FROM THE VILLAGE FORGE TO A GLOBAL CORPORATION

Our roots were planted in a small village smithy. The fact that a global corporation has emerged from these humble roots is also a result of our constant awareness of what our identity represents and what values the company has always embodied: Quality, innovation in product and process as well as reliability and sustainability in our internal and external customer relations. That is the basis of our pursuit for sustainable growth and quality leadership in our business fields.

Since 2016 we have been making our contribution to the DexKo Group, the world's leading manufacturers of axles and chassis components in the lightweight segment. We are proud to continue in successfully shaping this development together with DexKo and to convey our brand promise of quality, safety and comfort for our products and services to the world.



## VEHICLE TECHNOLOGY

Our vehicle technology products for motorhomes, caravans, commercial vehicles and commercial trailers guarantee the greatest safety and comfort. In any situation. With our premium solutions for vehicles in commercial use, we are meeting the most exacting customer requirements in terms

of ergonomics. For leisure vehicles we pave the way for a positive start to your holidays and a relaxed return home. We are always your reliable companion – for more joy on the road.



# HIGH-TECH COMPONENTS

## OUR INNOVATIONS FOR IMPROVED QUALITY OF LIFE

### STEADY LEGS

Page 30 – 32

### TORSION BAR SUSPENSION

Page 20

### LOWERED REAR

Page 12

### TOWBARS

Page 33

### CARRIER SYSTEMS

Page 34 – 41

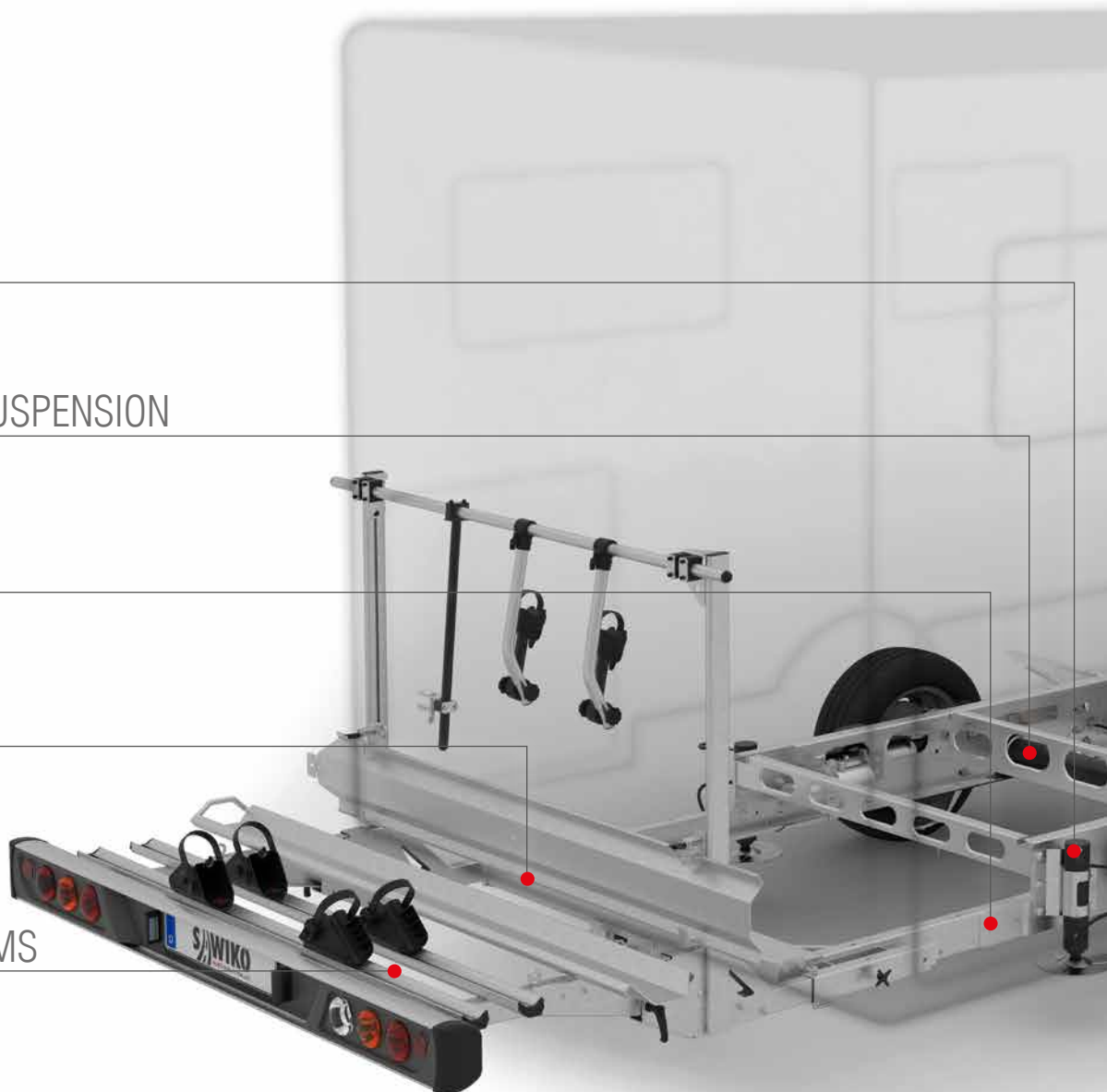

## COMFORT

Deeper, more flexible, smoother. AL-KO CHASSIS have a low centre of gravity, comfortable torsion bar suspensions or smooth air suspensions for maximum driving comfort.

## RELIABILITY

Enjoy your holiday from the very start! The well-engineered chassis components from AL-KO ensure that you can rely on your motorhome in any driving situation.



## ACS

Page 18

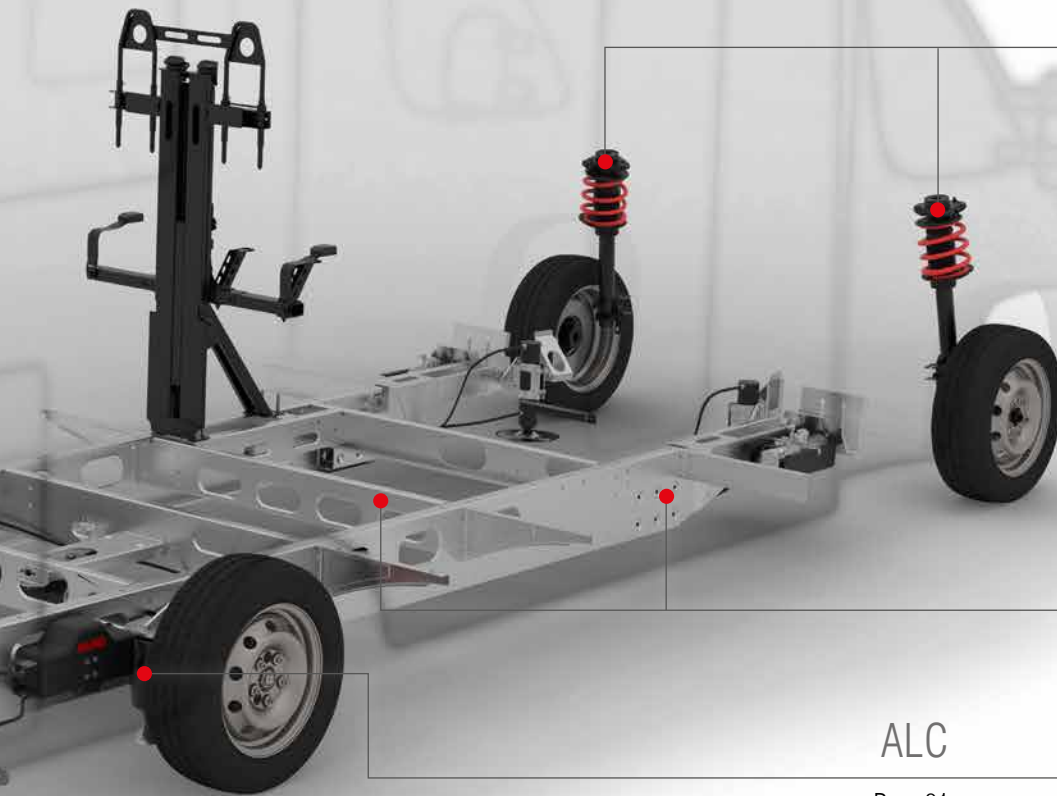

## CHASSIS TECHNOLOGY

Page 12

## ALC

Page 21

## AIR SUSPENSIONS

Page 22 – 25

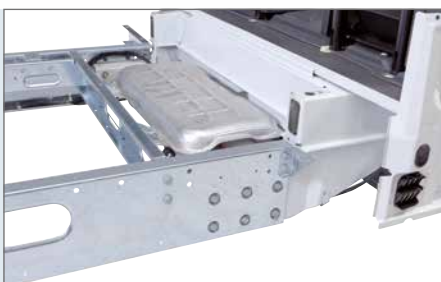



## EXPERIENCE

---

AL-KO has been developing and producing products for over 85 years. These products meet the needs of all customers with sophisticated and proven technology.

# AL-KO PRODUCTION HIGHEST STANDARDS AND QUALITY



## COOPERATION

---

The ongoing collaboration of the AL-KO Development department with leading car and motorhome manufacturers lays the foundation for improved safety, noticeably improved driving dynamics and maximum driving comfort with an AL-KO CHASSIS.

This know-how has made us a valued partner of the motorhome industry across the globe.



From component to product – precision and care  
define the manufacturing process



# AL-KO CHASSIS





# AL-KO CHASSIS



**MORE COMFORT AND  
MORE SAFETY**



## LIGHT, ROBUST AND DURABLE

Special perforations make the AL-KO CHASSIS lightweight. At the same time, high-strength steel ensures strong frame strength.

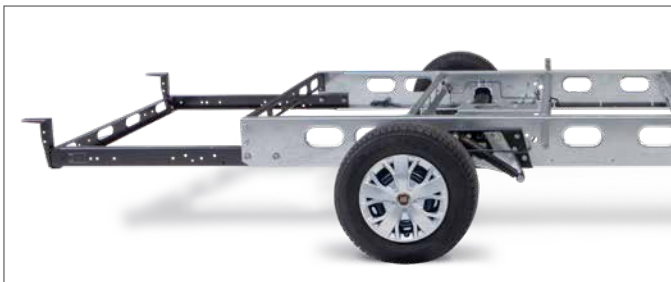

## FLEXIBLE LOADING

The AL-KO CHASSIS can be lowered down to 220 mm, which enables more storage space in the underfloor area. The lowered rear is ideally suited for use with rear garages.

## MORE COMFORT AND SAFETY

Modern chassis technology that is coordinated to the consistently high vehicle weights of motorhomes: Rear axle with torsion bar suspension and independent suspension for more comfort and more safety. Lower centre of gravity and wide track chassis ensure improved driving stability.





## PATENTED CONNECTION

The form-fitting shear cam screw connection ensures a perfect link between the AL-KO CHASSIS and the cab.



## LESS WEIGHT FOR MORE HOLIDAY FUN



## LIGHTWEIGHT CONSTRUCTION TECHNOLOGY

The innovative AL-KO lightweight construction technology saves weight without negatively affecting stability. Thus the loading capacity of the motorhome can be increased.



# AL-KO CHASSIS



## AXLES FOR WHEN THE BEST IS EXPECTED

## GENEROUS AND COMFORTABLE

---

The technology of the AL-KO CHASSIS enables longer wheelbases and optimally tuned overhangs. Numerous premium class manufacturers use this flexibility to realise more comfortable configurations.

As a 3-axle, the AL-KO CHASSIS allows longer vehicle lengths and higher permitted total weights. Therefore, AL-KO provides an optimal foundation for more generous motorhome structures.





## OF COURSE, YOUR FAVOURITE BRAND ALSO DRIVES WITH AL-KO



### THE PERFECT FOUNDATION

All prominent European motorhome manufacturers trust the AL-KO CHASSIS. Its innovative technology ensures configuration flexibility, enables more storage space and loading capacity, improves driving behaviour and ensures a relaxing holiday experience.

# CHASSIS COMPONENTS







# CHASSIS COMPONENTS

## **ACS – AL-KO COMFORT SUSPENSION NOW FOR A WIDE RANGE OF MOTORHOMES**

### MORE COMFORT

The ACS comfort suspension meets the highest comfort standards and was specially designed for the high demands of motorhomes. The suspension and absorption are optimised to each other and ensure an increase in driving stability on the front axle.

Hard impacts are mitigated significantly and the vibration dampening on the steering wheel decreases the stress and goes easy on the arms.





## UNIQUE

---

- | Impressive suspension comfort
- | Superb driving stability and enhanced driving safety
- | Reduced noise levels inside the vehicle
- | Raising of the vehicle standing height at the front axle
- | Robustness and longevity
- | Completely maintenance-free
- | For 2 and 3 axles
- | Replaces the standard original front axle strut
- | Available for OEM and retrofitting

# CHASSIS COMPONENTS

## TORSION BAR SUSPENSION – STANDARD

### DRIVING DYNAMICS LIKE A CAR

---

AL-KO, as the exclusive chassis manufacturer for motorhomes, relies on the torsion bar suspension as standard. This technology is superior to conventional suspension solutions for the consistently high loading capacities that are normal for motorhomes. The torsion bar suspension increases the power reserves of the AL-KO CHASSIS.



### STABLE AND SMOOTH

---

AL-KO CHASSIS rely on independent suspension with a standard torsion bar. This system is designed exactly for the respective axle load. It remains stable even under the most difficult road conditions and transforms bumps into gentle vibrations.



## STABLE LEVEL WITH EVERY LOAD

The ALC replaces conventional shock absorbers. The fully automatic system ensures the optimum driving level on the rear axle – and regardless of the load. Uneven or steep ramps thus become less threatening.



## ALC – THE AL-KO LEVEL CONTROLLER

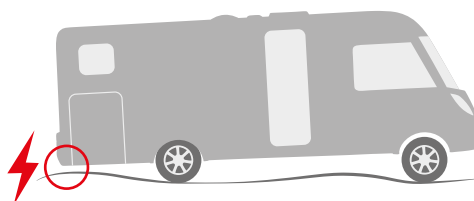

Without the ALC, there is a threat of making contact with the ground while loaded even with a short overhang.



Thanks to the ALC, the rear axle remains at an optimal level even when loaded. Ground clearance is maintained even with a longer rear overhang.

## SIMPLY RELAXED

The ALC contributes to a relaxing drive by way of a noticeable improvement in suspension and damping comfort, even on long journeys and when road conditions are difficult.

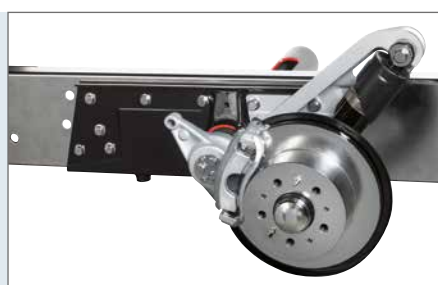

# CHASSIS COMPONENTS

## AIR PREMIUM X4 – FULL AIR SUSPENSION AT THE HIGHEST LEVEL

### YOU CAN'T GET MORE COMFORT THAN THIS

---

Front and AL-KO REAR AXLE(S) are equipped with an air suspension for the 4-circuit Air Premium X4 full air suspension. This helps to achieve unparalleled suspension comfort. In addition, the vehicle remains at a constant level during the trip – independent of the load status.



### COMPLETELY MAINTENANCE-FREE

---

The Air Premium X4 full air suspension enables the front axle to be raised up to +70 mm and lowered down to -60 mm. The rear axle can be raised up to +40 mm and lowered down to -50 mm. The complete system is maintenance-free and also suitable for vehicles with ESP.

## OPERATING UNIT

You can lower or raise the vehicle while going up to 25 km/h with just the push of a button. So driving onto a ferry is no longer a problem. The auto level function, an electronic level, automatically levels the vehicle when parked.



Maximum raising of the front axle, maximum lowering of the rear axle enables easy loading of the rear garage and/or load carrier

Raising of the front and rear axle, e.g. for rough terrain

Maximum raising of the driving level at the rear and lowering at the front, e.g. for ramps

Maximum lowering for easier loading / entry

Side levelling for a complete tank emptying

Manual levelling

Auto level function for a balanced living area when parked

Brief touch of the button: levelling of all axles to the driving level

Activation / Deactivation of the system and service button

Longer hold of the button: selection of the axle for manual levelling



# CHASSIS COMPONENTS

## AIR PREMIUM X2 – THE FULL AIR SUSPENSION FOR DYNAMICS AND COMFORT

### OPERATING UNIT

The fully automatic and maintenance-free Air Premium X2 air suspension system ensures superior suspension comfort at the AL-KO REAR AXLE(S). The rear axle can be raised up to +40 mm and lowered down to -50 mm using the remote control.



Manual  
levelling

Save mode 1

Save mode 2

Activation /  
Deactivation of  
the system and  
service button

Levelling the rear axle(s) to the  
driving level



### SAFETY WITH COMFORT

The electronic stability program ESP contributes highly to driving safety. The Air Premium X2, Air Plus and Air Top also make motorhomes with ESP more comfortable.





## AIR PLUS AND AIR TOP ADDITIONAL AIR SUSPENSIONS FOR ALL AL-KO CHASSIS AND ORIGINAL CHASSIS

### AIR PLUS

The manually-regulated Air Plus additional air suspension system for AL-KO CHASSIS enables you to change the rear slope angle. The control panel enables you to easily change the level on the rear axle from the cockpit, raising it up to +40 mm and lowering it down to -50 mm. This enables you to achieve optimal chassis adjustment that ensures maximum driving stability.



### AIR TOP

The additional air suspension Air Top for original chassis (base vehicles: Fiat Ducato, Peugeot Boxer and Citroën Jumper) enables easy raising of the rear axle up to a maximum of +50 mm via the compressor kit. Thus an imbalance on the pitch can be compensated for. The roll stability is also improved. Now also for vehicles with ESP.



### COMPRESSOR KIT

An ergonomic control panel for the cockpit and compressor is available for the Air Plus and Air Top additional air suspensions.



# CHASSIS ADVISOR



			ORIGINAL CHASSIS		VAN			
			Air Top	ACS	Air Top	ARS	ACS	ALC
<b>Fiat Ducato/</b>	From YoM 2006	Front axle		•			•	
		Rear axle	•		•	•		•
<b>Peugeot Boxer/</b>	Type X250	Front axle						
		Rear axle						
<b>Citroen Jumper</b>	YoM 1994 – 2006	Front axle						
		Rear axle	•		•			





**AL-KO CHASSIS**

2-axle				3-axle				
Air Plus	Air Premium X2	Air Premium X4	ACS	Air Plus	Air Premium X2	Air Premium X4	ACS	
		•	•			•	•	Front axle
•	•	•		•	•	•		Rear axle
								Front axle
								Rear axle

# COMFORT ACCESSORIES





# COMFORT ACCESSORIES

## HY4 – HYDRAULIC STEADY LEG SYSTEM

### SECURE FOOTING

The AL-KO HY4 hydraulic steady leg system ensures stability in the living area for motorhomes up to 6 t. The AL-KO HY4 also automatically levels the mobile home in the horizontal position in just one minute. The AL-KO HY4 is the only hydraulic steady leg system that doesn't require the installation of hydraulic components in the vehicle interior. Therefore, it is one of the most modern hydraulic systems on the market.

The AL-KO HY4 is intuitive and easy to use via the remote control in the driver's cab. Easy to understand buttons control the steady legs for manual and automatic levelling. In addition, two additional functions can be freely programmed in: for example your personal sleeping position and the tilt for emptying the waste water tank. Once purchased, the steady leg system can be easily reconfigured when you change vehicles so that even your new motorhome will have a steady footing. AL-KO HY4 comes with the usual, excellent AL-KO quality, is durable, robust, maintenance-free and quiet.

**NEW: Now available also for motorhomes with FIAT original chassis!**

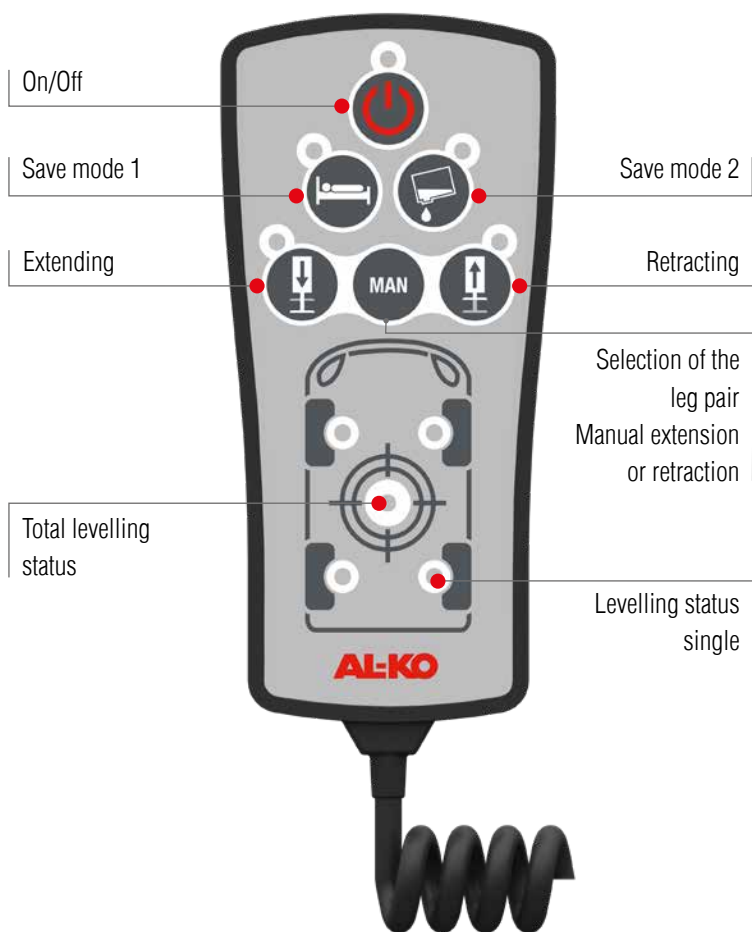



## UNIQUE

### **I Clean and space saving –**

no more bulky hydraulic components in the vehicle interior.

### **I Intuitive LED remote control –**

millimetre-precise levelling in only a minute.

### **I Optimum weigh distribution –**

four independent hydraulic assemblies directly on the chassis.

### **I High professional quality –**

certified chassis connection from the chassis specialist.

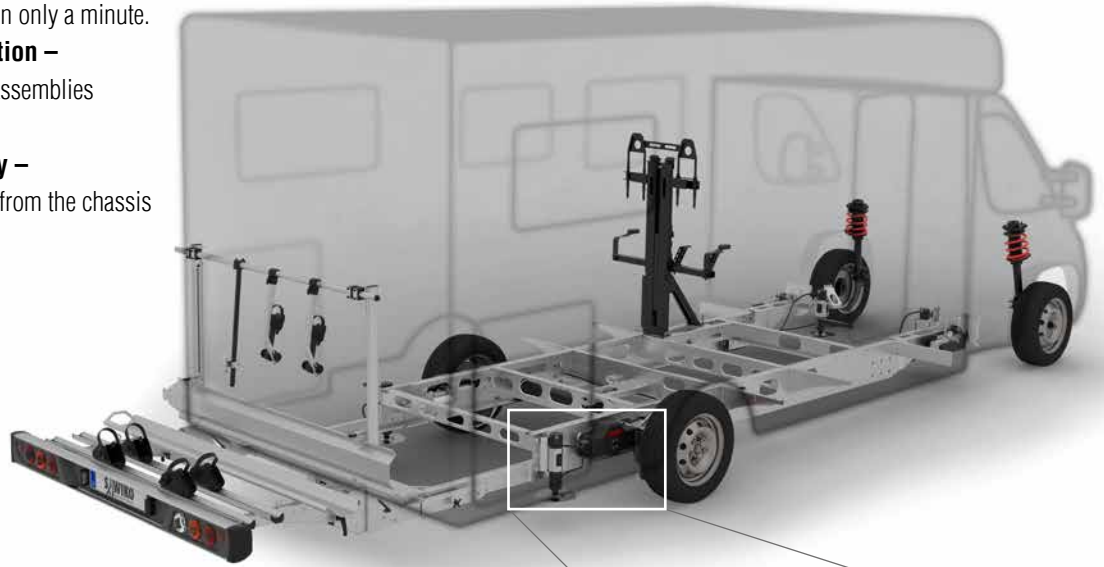

# COMFORT ACCESSORIES

## PLASTIC STANDS AND STEADY LEGS – STABLE ON ANY TERRAIN



### AREX LIGHT II PLASTIC STANDS

This stand will wow you with their extreme user-friendliness like all of our products. It is telescopic. The stand set has an extremely low weight of under 4 kg per pair (simple telescopic version). This saves you up to 50 % in weight compared to other steel legs. Naturally, the AREX Light II plastic steady leg also provides an absolutely secure footing and is thus the easiest way to securely support your vehicle. Last but not least, this support is also ensured by an aluminium vehicle connection and a hardened and galvanised steel spindle.



### CLICKFIX STEADY LEGS

The most beautiful places to park are often those where the ground is uneven or sloping. With the ClickFix steady leg, you don't have to miss out on these attractive travel destinations. Its stable construction ensures secure footing on grass, gravel or asphalt.

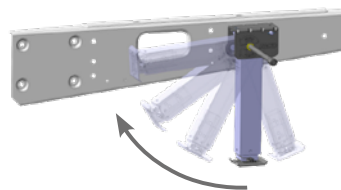

A half turn of the extending crank is enough to make the **ClickFix steady leg** ready for action. When the motorhome is ready to take off travelling, the safety mechanism folds the steady leg up or back. Thus damage is prevented.



## MORE FUN WITH TRAILERS

Taking your own boat, quad bike or motorcycle on holiday makes it that much more fun. Thanks to SAWIKO towbars, your toys are always close at hand. Thus increasing the leisure time value of your motorhome.



## TOWBARS AND FRAME REINFORCEMENTS



**AHK MT 005**

For all AL-KO CHASSIS and vehicles with AL-KO and other load-bearing frame extensions, also available for vehicles without a load-bearing frame extension (reinforcement add-on required).



**AHK MT 005 with removable ball system**

Optional for all common SAWIKO towbars, the removable system is easily installed as an intermediate piece and the original ball head can continue to be used.



**MT 052**

Continuously adjustable, maximum width 1420 mm.



**MT 054**

Towbar with removable and lockable ball head. Suitable for AL-KO high and low frame chassis with or without rear lowering and for the Original chassis.



**MT 001**

The figure shows the version for the Fiat Ducato X230/X244.

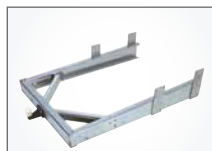

**MT 010**

Heavy load towbars in straight or suspended form can only be used for vehicles with high trailer loads.



**MT 015**



**MT 017**

The space saving version is predominately used for flat beds or vehicles with problematic substructures. Roller fixing up to 130 kg.



**MT 026**

Used for the Ducato X250.

These versions can be used as a standard coupling for all vehicles without a frame extension or for non-load-bearing frame extensions. The attachment elements for carrier systems to the coupling can be retrofitted at any time without problem.

## EASY INSTALLATION, SECURE MOUNTING

SAWIKO towbars are perfectly optimised for the AL-KO CHASSIS. All attachment points have been available since chassis production date 8/95. No drilling is required. This guarantees easy assembly and the highest level of safety.

# CARRIER SYSTEMS





# CARRIER SYSTEMS



## VELO III – THE CARRIER SOLUTION FOR E-BIKES

### STOWED SECURELY

E-bikes are often heavier and wider than normal bicycles. Therefore, the Velo III carrier system is specially designed to stow up to two e-bikes securely and effortlessly while on holiday.



### VELO III

- | Load capacity: up to 80 kg
- | Conversion kit for 2 e-bikes or 3 bicycles
- | Low loading depth
- | Net weight: approx. 16 kg
- | Can be removed without tools
- | Conversion kit for 3 bicycles available as an option
- | Folding platform



## MIKRO II – THE REBIRTH OF THE CLASSIC CARRIER

### PERFECT FOR YOUR SCOOTER

With a load capacity of 120 kg, you can take practically any 125 cc scooter or up to 4 bicycles with you. It is bolted to the vehicle chassis using two galvanised attachment elements. The carrier can be removed at any time, and can be simply pushed into the permanently bolted attachment elements when required.



### MIKRO II

- | Load capacity: up to 120 kg
- | EC type approval
- | For max. 4 bicycles or 1 scooter + 1 bicycle
- | Variable loading depth (optional)
- | Made from aluminium and steel
- | Can be removed without tools



All SAWIKO rear garage systems can be used when you change vehicles. You merely have to remount the attachment elements (also applies to the following pages).



## VARIO – FOLDABLE, COMPACT AND VARIABLE



### HIGH-QUALITY

The VARIO is manufactured from aluminium for the most part, and consists of high-quality components – such as the bicycle rails customised for e-bikes and retaining arms, or the cross beam made of stainless steel. Despite its low net weight of approx. 29 kg without conversion kits, the VARIO has a loading capacity of 150 kg.

### FLEXIBLE AND FUNCTIONAL

When the VARIO is not needed, it can be easily folded up in just a few steps. The carrier can remain on the vehicle without taking up any space.

In addition to its practical folding function the VARIO has a variable loading depth and can be extended from 620 up to 800 mm.

### VARIO

- | Load capacity: up to 150 kg
- | EC type approval
- | For 1 scooter, 4 bicycles or  
1 scooter + max. 2 bicycles
- | Made from aluminium for the most part
- | Can be removed without tools
- | High-quality, user-friendly design
- | Variable loading depth from 620 to 800 mm
- | Platform with folding function
- | Bicycle rails and retaining arms with  
ratchet quick-release mechanism
- | Dimensions: Width: 2011 mm / Depth: 937 mm



#### Folding function

Loosen the lever on the light bracket and the platform, fold up and retighten.



#### Practical

Ratchet quick-release on the retaining arms and bicycle rails. The soft padding protects against scratches.

# CARRIER SYSTEMS



## LIGERO III – FLEXIBLY PACKED

### VERSATILE APPLICATION

The now 3rd generation of the LIGERO supersedes the well-known LIGERO I + II load carriers in a single version. The design of the LIGERO III impresses not only with its functionality, but also with its attractive appearance. The elegantly designed light bracket contributes significantly to that. The main carrier, motorcycle tray, ramp and light bracket are, of course, made of aluminium and are also powder-coated.



### LIGERO III

- | Load capacity: up to 150 kg
- | EC type approval
- | For 1 scooter or max. 4 bicycles  
or for 1 scooter + 2 bicycles
- | Variable loading depth – telescopic to  
max. 821 mm loading depth
- | Can be removed without tools



### MOTORCYCLE TRAY MODEL 3000

Integrated, anti-slip ramp, strap set and wheel strap make loading and securing the two-wheeler easy.  
The aluminium construction can be retrofitted at any time.

## BACKPACK 150 – FOR EVEN MORE FREEDOM ON HOLIDAY

### THE BEAUTIFUL PREMIUM SOLUTION

When designing the new Backpack 150, lightweight construction and the highest user-friendliness were always the focus. Therefore, the carrier can be removed without tools. A drive-on ramp helps with secure loading of the scooter/motorcycle.



### AL-KO BACKPACK 150

- | Load capacity: up to 150 kg
- | Loading depth 570 mm or 720 mm
- | High-quality, user-friendly design
- | Retaining strap as standard
- | Drive-on ramp as standard with scooter version
- | Can be removed without tools
- | For all standard motorhomes
- | Available in the basic versions "bicycle carrier" or "scooter"



### UNIVERSAL STRAP SET

Contains 4 lashing straps with hooks, 2 chocks, 1 retaining arm and a piece of protective hose for the lashing straps.

# REAR GARAGE SYSTEMS



## TRINEO – THE ELECTRIC GARAGE ENTRANCE FOR SCOOTERS

### LIGHT, SPACE SAVING AND EASY

This sums up the outstanding characteristics of the Trineo. It only weighs approx. 22 kg. incl. the folding ramp.



Only the guide rails with the electric motor and the front wheel sled need to be installed in your rear garage. You can easily remove the wheel sled to save even more space when not using the Trineo.

The Trineo has a payload of 150 kg, making it suitable for most scooter models. To load your vehicle, you only have to place the front wheel in the sled and tighten the crank. Then you can easily use the remote control to move your scooter into the rear garage. Finally, just attach the rear of the scooter, e.g. to our lashing rail using lashing straps.



### TRINEO

- | Low net weight: with folding ramp approx. 22 kg
- | Easy loading with electric motor and remote control
- | Infinitely variable tyre fixing
- | Low space requirement
- | Load capacity 150 kg, left- or right-side installation possible



# TRAILERS



## WHEELY – THE VERSATILE CHAMPION

### ON YOUR OWN WHEELS

---

Wheely stands out in any conceivable situation with its universal usability. Its sophisticated flexibility ensures the highest level of holiday comfort.



### WHEELY

---

- | Permitted gross weight approx. 750 kg
- | Usable area: 2,000 x 800 mm (plus 300 mm for extendable light bracket, optional)
- | Ideal for relieving the weight on your motorhome
- | Versatile fitting options (e.g. storage boxes, spare wheel holder, side walls)
- | 100 km/h permit possible
- | Net weight: approx. 215 kg

# TECHNICAL DATA AND PRICES

Technical data and prices (manufacturer's recommended retail price), as of 08/2018





Chassis manufacturer	Year of manufacture	Variant	Recom. front axle load range	Part no.	Sales price € *
Comfort suspension for motorhomes with an AL-KO chassis	from 2006	Light	1600 kg – 1850 kg	1710620	820.–
		Heavy	1800 kg – 2100 kg	1710621	820.–
Comfort suspension for motorhomes with an AL-KO chassis	from 2006	Light	1600 kg – 1850 kg	1710038	**1126.–
		Heavy	1800 kg – 2100 kg	1710039	**1126.–
Comfort suspension for motorhomes with Fiat, Peugeot or Citroen original chassis	from 2006***	Light	1480 kg – 1640 kg	1710624	871.–
		Middle	1600 kg – 1850 kg	1710625	871.–
		Heavy	1800 kg – 2100 kg	1710626	871.–
Comfort suspension for motorhomes with Fiat, Peugeot or Citroen original chassis	from 2006***	Light	1480 kg – 1640 kg	1710287	**1229.–
		Middle	1600 kg – 1850 kg	1710288	**1229.–
		Heavy	1800 kg – 2100 kg	1710305	**1229.–



\* incl. VAT. \*\* incl. Original Fiat Domlager Kit \*\*\* Production date 2006–2011 not approved in England and France

## ALC – AL-KO LEVEL CONTROLLER

**Nivomat for AL-KO rear axles based on Fiat Ducato, Peugeot Boxer and Citroen Jumper (2-axle vehicles from type X250)**

Only possible for 2-axle vehicles.

### Product advantages

- I Automatic, load-independent regulation of the rear axle at the pre-set level
- I Improvement of suspension and damping comfort
- I 100% maintenance-free
- I Now also for vehicles with ESP

### Installation

The ALC is mounted at the location of the shock absorber on the rear axle of the vehicle. While driving, it takes over a part of the load that would otherwise be handled exclusively by the torsion bar axle. ALC thus noticeably improves the suspension and damping comfort, and contributes to relaxed and non-tiring driving. Therefore, you are well prepared for any road surface. Suitable as original equipment or for retrofitting. Retrofitting possible in selected specialist workshops and at the AL-KO Customer Centres

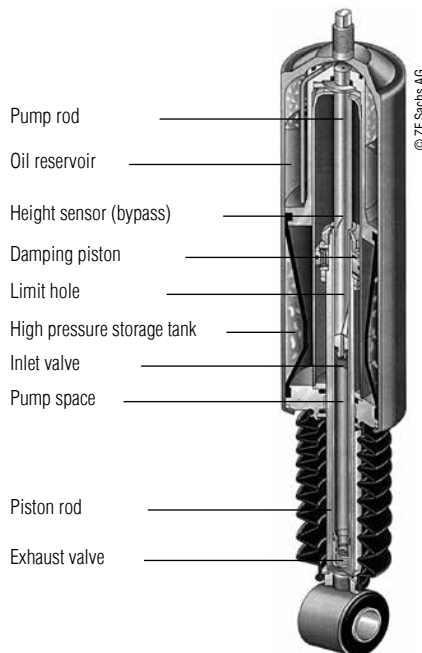

### Prices

For original equipment prices please contact your body manufacturer directly. Retrofitting upon request (some of your vehicle data is required for preparation of a quote – for more information, please see the contact form).

## AIR PREMIUM X4

**4-circuit full air suspension for front and AL-KO rear axle(s) based on Fiat Ducato, Peugeot Boxer and Citroën Jumper (type X250). Manual lowering or raising of the vehicle possible up to a speed of 25 km/h.**

### Product advantages

- I Adjustment track in the axle range of the front axle: Raising approx. +70 mm / lowering approx. -60 mm
- I Adjustment track in the axle range of the rear axle: Raising approx. +40 mm / lowering approx. -50 mm

- I Fully automatic, load-independent level control on the front and AL-KO rear axle(s)
- I Optimum suspension comfort with high driving stability
- I Auto-level function – automatic levelling of the vehicle when parked (as part of the axle suspension travel)
- I 100 % maintenance-free
- I Self-sufficient air supply thanks to built-in compressor
- I Now also for vehicles with ESP

### Installation

Suitable as original equipment or for retrofitting. Retrofitting possible in selected specialist workshops and at the AL-KO Customer Centres

### Prices

For original equipment prices please contact your body manufacturer directly. Retrofitting upon request (some of your vehicle data is required to generate a quote – for more information, please see the contact form).

**2-circuit full air suspension for AL-KO rear axle(s) based on Fiat Ducato, Peugeot Boxer and Citroën Jumper (type X250). Manual lowering or raising of the vehicle possible up to a speed of 25 km/h.**

#### Product advantages

- I Adjustment track in the axle range of the rear axle: Raising approx. +40 mm / lowering approx. -50 mm
- I Automatic, load-independent level control on the rear axle(s)

- I 100 % maintenance-free
- I Self-sufficient air supply thanks to built-in compressor

#### Installation

Suitable as original equipment or upgrade  
Retrofitting possible in selected specialist workshops and at the AL-KO Customer Centres

#### Prices

For original equipment prices please contact your body manufacturer directly. Retrofitting upon request (some of your vehicle data is required to generate a quote – for more information, please see the contact form).

## AIR PLUS

**The AL-KO Air Plus additional air suspension is available as optional special equipment for an AL-KO chassis (2- and 3-axle vehicles) based on Fiat Ducato, Peugeot Boxer and Citroën Jumper (type X250). Manual lowering or raising of the vehicle possible up to a speed of 25 km/h.**

#### Product advantages

- I Adjustment track in the axle range. Rear axle: Raising max. +40 mm / lowering down to -50 mm
- I 100 % maintenance-free
- I Integrated emergency running function

#### Prices

Retrofitting upon request (some of your vehicle data is required to generate a quote – for more information, please see the contact form).

## AIR TOP

**Additional air suspension for use with the original chassis (lead frame, special chassis, flat bed and van). Possible base vehicles: Fiat Ducato, Peugeot Boxer, Citroën Jumper**

#### Product advantages

- I Manually raise the rear axle by up to a max. +50 mm while stationary
- I 100 % maintenance-free
- I External air supply (e.g. mobile 12 V compressor). Optional integrated compressor kit available.
- I Now also for vehicles with ESP (Type X250 from model year 2011)

#### Approval

Vehicle documents must be altered accordingly based on part certificate of conformity.

#### Permitted gross weights X230, X244

Permitted in Europe based on EC brake certificate of conformity<sup>1</sup>

- I Type 14/15 up to 3,400 kg permitted total weight<sup>2</sup>
  - I With and/or without ABS

- I Type 18/Maxi up to 3,500 kg permitted total weight<sup>2</sup>
  - I With and/or without ABS
  - I Special case: Permitted in Germany based on part certificate of conformity<sup>3</sup>
- I Type 14/15 up to 3,500 kg permitted gross weight
  - I With and/or without ABS
  - I Min. empty weight 2,500 kg
  - I Minimum rear axle weight 1,250 kg (with screw-in controller)
  - I Tyre load capacity index min. 109/107 Q
- I Type 18/Maxi up to 3,500 kg permitted gross weight
  - I With and/or without ABS
- I Type 18/Maxi up to 3,850 kg permitted gross weight
  - I With or without ABS for vehicle class M14
  - I Min. empty weight 2,500 kg
  - I Minimum rear axle weight 1,250 kg (with screw-in controller)
  - I Tyre load capacity index min. 110/108 Q
- I Type 18/Maxi up to 4,000 kg permitted gross weight
  - I With ABS
  - I Min. empty weight 2,500 kg
  - I Min. weight rear axle 1,250 kg
  - I Tyre load capacity index min. 113/111 Q
- I For vehicles without ABS, a screw-in controller must be ordered separately (not part of the scope of supply)!

#### Permitted gross weights X250

Permitted in Germany based on part certificate of conformity<sup>5</sup>

- I Type 35
  - I Without ESP up to 3,700 kg permitted total weight<sup>2</sup> (Tyre load capacity index min. 109/107 Q)
  - I With ESP up to 3,500 kg permitted total weight<sup>6</sup>
- I Type 36.5
  - I Without ESP up to 3,700 kg permitted total weight<sup>2</sup> (Tyre load capacity index min. 109/107 Q)
  - I With ESP up to 3,650 kg permitted total weight<sup>6</sup>
- I Type 35 Maxi
  - I Without ESP up to 3,850 kg permitted total weight<sup>2</sup> (Tyre load capacity index min. 116/114 Q)
  - I With ESP up to 3,500 kg permitted total weight<sup>6</sup>
- I Type 40/42.5 Maxi
  - I Without ESP up to 4,250 kg permitted total weight<sup>2</sup>
  - I With ESP up to 4,250 kg permitted gross weight<sup>2,6</sup> (Tyre load capacity index min. 116/114 Q)

<sup>1</sup> Type 14/15: e11\* 71/320\*2002/78\*4639\*01, Type 18/Maxi: e11\* 71/320\*2002/78\*4638\*01.

<sup>2</sup> The max. permitted front and rear axle loads of the original base vehicle must not be exceeded.

<sup>3</sup> 375-0007-05-FBKV.

<sup>4</sup> Vehicle class can be obtained from the respective body manufacturer.

<sup>5</sup> 07-00015-CX-GBM.

Designation	Suitable for	Weight kg	Part no.	Sales price €
AL-KO Air Top kit for single/double layered leaf springs	Vehicles with ABS – Types X230 and X244 Fiat Ducato / Peugeot Boxer / Citroën Jumper	12.5	222 619	655.–*
AL-KO Air Top kit for single/double layered leaf springs	Vehicles with ABS – (standard), Type X250 Fiat Ducato / Peugeot Boxer / Citroën Jumper	9.5	1 250 945	655.–*
Screw-in controller kit	Vehicles without ABS – Types X230/X244	0.5	420 150	76.– *
Compressor kit	Fiat Ducato/Peugeot Boxer/Citroen Jumper Type X250		1 569 093	391.–*

\* Does not include installation

Designation	Part no.	Sales price €
HY4 X250 AL-KO chassis standard kit AHS 317 (cylinder length front & rear 317 mm)	1 710 658	5,125.-*
HY4 X250 AL-KO chassis special kit low AHS 277 (cylinder length front 317 mm, rear 277 mm)	1 710 851	5,125.-*
HY4 X250 Fiat original chassis EHA (installation behind the rear axle outside)	1 710 852	5,195.-*
HY4 X250 Fiat original chassis EHI (installation connection in front of / behind the rear axle inside)	1 710 853	5,195.-*

\*without installation (incl. assemblies, controller/electrics, brackets and small parts)

## AREX LIGHT II

Designation	Implementation	Part no.	Sales price €
2 plastic stands AREX-Light II	Single telescopic	1629788	215.-
2 plastic stands AREX-Light II	Double telescopic	1629789	245.-

## CLICKFIX STEADY LEGS

### Mechanical steady legs for vehicles with AL-KO frames or frame extensions

#### Product advantages

- I Robust steady legs for firm and secure footing
- I Fast and comfortable operation: just a half-turn of the crank and the steady leg is in the vertical support position
- I Independent tensioning of the steady leg while winding up
- I Safety mechanism when setting off with legs folded down

#### Technical data

Static load capacity: 1,000 kg  
Dynamic load capacity 500 kg

#### Scope of delivery

Two steady legs, assembly materials, assembly/installation instructions. Order crank separately.

#### Selecting the best mechanical AL-KO steady leg for the job

1. Determine the frame height "A" when loaded
2. Using this data you can select the corresponding leg from the order overview
3. The selected leg has a certain operating range "F" which must be free on your vehicle

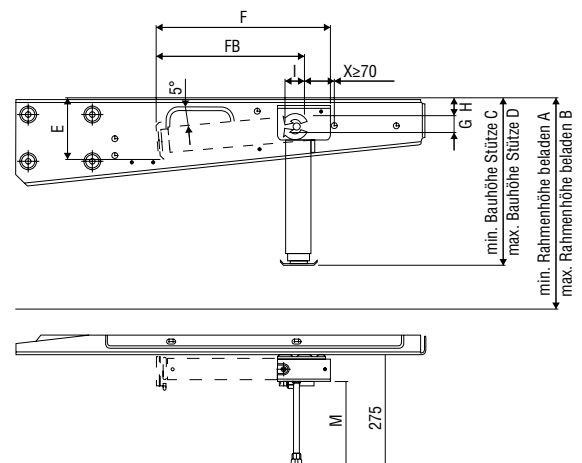

Required frame height		Leg dimensions leg height		Mounting dimensions						Drive shaft length	Net weight**	Part no.	Sales price €
min. A mm	max. B mm	min. C mm	max. D mm	E mm	FB mm	F mm	G mm	H mm	I mm	M mm	Set in kg		
310	424	281	445	140	302	364	40	41.5	45	200	7.2	1 239 362	283.-
320	440	297	464	142	320	382	40	41.5	45	200	7.3	1 239 363*	283.-
420	624	397	654	150	419	481	40	41.5	45	200	8.4	1 239 364*	283.-
460	710	446	744	155	469	531	40	41.5	45	200	8.9	1 239 365*	283.-

\* The length of the legs can be manually adjusted via a cotter pin.

\*\* For complete leg set (two units) including screw/mounting material (0.8 kg).

ClickFix steady leg accessories	Net weight in kg	Part no.	Sales price €
Galvanised extending crank 665 mm long	0.6	205 520	12.-
Galvanised extending crank 865 mm long	0.8	267 363	12.-

### Calculation of the required D value of the towbar

The D value and the imposed load of the tow ball with the holder may not be exceeded.

The D value results from the permitted gross weight of the vehicle and the permitted trailer load.

$D = \frac{T \times R \times 9.81}{(T + R) \times 1,000}$	$T = \frac{D \times R \times 1,000}{(R \times 9.81) - (1,000 \times D)}$	$R = \frac{D \times T \times 1,000}{(T \times 9.81) - (1,000 \times D)}$
<b>D</b> = D value in kN	<b>T</b> = gross weight of the towing vehicle in kg	<b>R</b> = gross weight of the trailer in kg

Designation	Part no.	Sales price €
SAWIKO towbar for vans, e.g. Fiat, Mercedes, Renault and others...	30.955	355.–
SAWIKO removable towbar for Fiat Ducato X250/X290 vans	30.956	455.–
SAWIKO towbar for AL-KO chassis or vehicles with a certified frame extension without reinforcing parts	31.100	from 549.–
SAWIKO towbar for series chassis with certified frame extension incl. required reinforcing parts (not Ducato X250)	31.200	from 710.–
SAWIKO standard towbar for series chassis with overhangs for which no or one load-bearing frame extension is mounted	30.100	from 829.–
SAWIKO heavy load towbar for series chassis for which trailer loads of more than 2,000 kg are required	31.500	799.–
SAWIKO heavy load towbar for series chassis with overhangs for which no or one load-bearing frame extension is mounted and a trailer load of more than 2,000 kg is required	30.500	938.–
SAWIKO removable ball system without ball head	31.990	295.–

Electric kit	Designation	Part no.	Sales price €
AL-KO universal 13-pin (Jaeger)	Fiat Ducato, Peugeot Boxer, Citroën Jumper Type X230	299 837	153.–
AL-KO vehicle-specific 13-pin	Fiat Ducato, Peugeot Boxer, Citroën Jumper Type X244	201 628	157.–
AL-KO vehicle-specific 13-pin (LED-capable)	Fiat Ducato, Peugeot Boxer, Citroën Jumper Type X250	1 629 090	203.–
AL-KO vehicle-specific 13-pin	Renault Master, Opel Movano, Nissan Interstar Type X70	201 653	75.–
SAWIKO electrical cable set 13-pin	Other		from 85.–

Adjustable AHK	Part no.	Sales price €
MT052 cross member up to max. 1420 mm (A) without ball head infinitely variable, without ball head approx. 24.8 kg	31W10440A0	570.–
MT052 cross member up to max. 980 mm without ball head	31W10000A0	570.–
Connection plate (L/R)	31W1000100	65.–
Imposed load 80 kg, max. D value 13.1 kN, offset (B) +/- 27 mm, EC certification available		
Diagonal strut uni (optional)	31WE345000	74.–

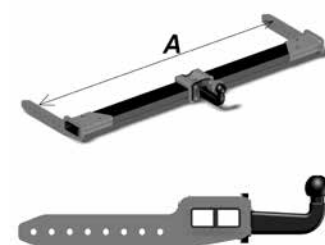

MT052 cross member incl. ball head up to max. ...	...980 mm: Part no.	...1,420 mm: Part no.	Sales price €
Type 1	31W10000A1	31W10440A1	620.–
Type 2	31W10000A2	31W10440A2	620.–
Type 3	31W10000A3	31W10440A3	620.–
Type 4	31W10000A4	31W10440A4	620.–
Type 5	31W10000A5	31W10440A5	620.–



MT 054	Part no.	Sales price €
Towbar with removable and lockable ball head	On request	from 800.–

## VELO III

Page 36

Designation	Part no.	Sales price €
VELO III 2 folding electric bikes without electric cable set	21.300	945.–
VELO III 3 folding electric bikes without electric cable set	21.310	1,015.–
Reinforcement parts / frame extension for vehicles without load-bearing chassis or frame extension	On request	from 300.–
Other reinforcement parts for vehicles with approved chassis extension	On request	from 149.–

## MIKRO II

Page 36

Designation	Part no.	Sales price €
Complete MIKRO II system for 1 scooter	10.310	899.–
Complete MIKRO II system for 1 scooter + 1 bicycle	10.320	949.–
Complete MIKRO II system for 2 bicycles	10.330	859.–
Complete MIKRO II system for 3 bicycles	10.340	909.–
Complete MIKRO II system for 4 bicycles	10.350	959.–
Reinforcement parts / frame extension for vehicles without load-bearing chassis or frame extension	On request	from 300.–
Other reinforcement parts for vehicles with approved chassis extension	On request	from 149.–

\* Excluding electrical cable set incl. standard attachment elements for frame connection.



Designation	Part no.	Sales price €
Complete VARIO system for 1 scooter	10.710	1,299.–
Complete VARIO system for 1 scooter + 1 bicycle	10.720	1,369.–
Complete VARIO system for 1 scooter + 2 bicycles	10.730	1,439.–
Complete VARIO system for 2 bicycles	10.740	1,299.–
Complete VARIO system for 3 bicycles	10.750	1,369.–
Complete VARIO system for 4 bicycles	10.760	1,439.–
Reinforcement parts / frame extension for vehicles without load-bearing chassis or frame extension	On request	from 300.–
Other reinforcement parts for vehicles with approved chassis extension	On request	from 149.–

\*Excluding electrical cable set

Designation	Part No.	Sales price €
Complete LIGERO III system for 1 scooter	10.510	1,099.–
Complete LIGERO III system for 1 scooter + 1 bicycle	10.520	1,169.–
Complete LIGERO III system for 1 scooter + 2 bicycles	10.530	1,239.–
Complete LIGERO III system for 2 bicycles	10.540	1,099.–
Complete LIGERO III system for 3 bicycles	10.550	1,169.–
Complete LIGERO III system for 4 bicycles	10.560	1,239.–
Reinforcement parts / frame extension for vehicles without load-bearing chassis or frame extension	On request	from 300.–
Other reinforcement parts for vehicles with approved chassis extension	On request	from 149.–

\* Excluding electrical cable set incl. standard attachment elements for frame connection.

Designation	Part no.	Sales price €
Strap set contains 4 straps with hooks, 2 wheel chocks, 1 retaining arm and 1 protective sheath for straps	10.900	119.–

Designation	Part no.	Sales price €
AL-KO Backpack 150 (motorcycle carrier version) for AL-KO chassis with rear extension	1 730 271	1,619.–
AL-KO Backpack 150 (motorcycle carrier version) for original chassis with other frame extension		1,720.–
AL-KO Backpack 150 (bicycle carrier version) for AL-KO chassis with rear extension	1 730 272	1,619.–
AL-KO Backpack 150 (bicycle carrier version) for original chassis with other frame extension		1,720.–
Scooter conversion kit	1 629 426	354.–
Platform extension conversion kit	1 629 427	202.–
Retaining rod	1 629 428	66.–
Retaining arm	1 629 429	80.–
Bicycle conversion kit (position 1 / retaining arm 240 mm)	1 629 430	50.–
Bicycle conversion kit (position 2 / retaining arm 420 mm)	1 629 431	60.–
Bicycle conversion kit (position 3 / retaining arm 600 mm)	1 629 432	60.–
Bicycle conversion kit (position 4 / retaining arm with clamp bridge)	1 629 433	70.–
Surcharge for reinforcing parts for vehicles with non load-bearing AL-KO chassis or frame extension	31.220	198.–

Electric kit	Designation	Part No.	Sales price €
Universal, 13-pin (Jaeger)	Fiat Ducato, Peugeot Boxer, Citroën Jumper Type X230	299 837	157.–
Vehicle-specific, 13-pin	Fiat Ducato, Peugeot Boxer, Citroën Jumper Type X244	201 628	159.–
Vehicle-specific 13-pin (LED-capable)	Fiat Ducato, Peugeot Boxer, Citroën Jumper Type X250	1 629 090	205.–
Vehicle-specific, 13-pin	Renault Master, Opel Movano, Nissan Interstar Type X70	201 653	67.–

## TRINEO

Designation	Part no.	Sales price €
Trineo	25.600	1,380.–

**Scope of delivery:** Mechanical lift device with electric motor (installation area 2,000 x 500 mm), front wheel sled, 2 remote controls: 1x small for key ring, 1x large for e.g. glove compartment, folding ramp, lashing straps

## WHEELY

Technical data	
Usable area	2,000 x 800 mm plus 300 mm for extension
Loading height	620 mm
Empty weight without accessories	approx. 215 kg
Perm. total weight	approx. 750 kg
Total length	min. 1,800 mm, max. 2,450 mm
Total width	approx. 2,250 mm



Designation	Part No.	Sales price €
WHEELY single axle trailer without conversion kit	70.5000	1,880.–
WHEELY single axle trailer, braked version excluding conversion kit	70.5555	2,150.–
100 km/h permit	70.5003	40.–
TÜV - individual acceptance loading from 750 kg to 950 kg, braked trailer	70.5008	100.–
Conversion kit for 1 scooter	70.5100	156.–
Conversion kit for extendable bumper	70.5125	208.–
Conversion kit 1 bicycle on extendable bumper	70.5145	80.–
Conversion kit 1 bicycle in front of retaining strap	70.5177	156.–
Spare wheel holder for trailer wheel	70.5306	70.–
Spare wheel 195/50/R13 loose on steel rim	70.5304	153.–
Mechanical lift device for motorcycles	70.5366	970.–
Mechanical lift device – conversion kit for 2nd motorcycle	70.5368	520.–
Load area extension to 1,100 mm	70.5505	368.–
Basic tarpaulin system	70.5411	1,020.–
Comfort tarpaulin system	70.5412	1,225.–
Ultra Box 360 lockable for V-drawbar	70.5325	565.–
Conversion kit for 1 motorbike	70.5150	260.–
WHEELY aluminium side walls, 300 mm high	70.5400	305.–
WHEELY aluminium side walls, 600 mm high	70.5405	553.–
WHEELY-Duo aluminium side walls, 300 mm high	70.6520	395.–
WHEELY-Duo aluminium side walls, 600 mm high	70.6530	712.–
MP3 conversion kit with three-part loading ramp	70.5133	395.–
Conversion kit 2 bicycles in front of retaining strap	70.5178	205.–
150 mm coupler extension for TRAIGO 500	1 730 076	80.–
Aluminium box for V-drawbar, lockable	70.5320	235.–
V-drawbar basic bracket (necessary for plastic and aluminium box)	70.5300	95.–
Plastic box (black) for V-drawbar, lockable	70.5310	122.–
Conversion kit 2 bicycles on expendable bumper	70.5175	156.–
Scooter running board clamping system (max. tunnel height 100 mm)	28.210	145.–
Scooter running board clamping system (above tunnel height 100 mm)	28.220	175.–
Conversion kit for raising the clamping device (with 28.210 only)	28.211	40.–
Folding lock with additional brake disc lock	70.5365	89.–
Spare wheel holder for towing vehicle wheel under the platform	70.5200	100.–
"Basic" strap set	70.5107	52.–
"Premium" strap set with hooks and Spannfix	70.5105	100.–
Manual cable winch with deflection	70.5360	100.–
Elevated drive-on ramp, prevents road contact	72.5152	45.–
Folding, drive-on ramp, curved, up to 340 kg load	70.5156	120.–
Retaining arm to secure trailing arm	70.5110	77.–
Ring bolt set	70.5108	10.–

# AL-KO

QUALITY FOR LIFE



## AL-KO CLUB

---

"Every euro one point" is the rule for AL-KO Club members. Valid for the purchase of AL-KO, E&P, SAWIKO and Winterhoff accessories. There are valuable rewards from the AL-KO Vehicle Technology product range for the bonus points.

And the replacement programme is not the only advantage of an AL-KO Club membership. Club members will also receive the AL-KO Club newsletter via e-mail on a regular basis. Along with first-hand information, you could also win attractive prizes, e.g. regarding tickets to the large Caravanning trade show in Germany.

Other high-quality, material prizes from the product ranges of AL-KO, E&P, SAWIKO and Winterhoff can also be won by all AL-KO Club members on an annual basis.

Membership of the AL-KO Club is free and can be cancelled at any time. Becoming a member is easy: Register free at [www.alko-tech.com/club](http://www.alko-tech.com/club) and profit from the many advantages.

### **ALOIS KOBER GMBH**

Ichenhauser Str. 14  
89359 Kötz  
Germany  
Phone: +49 8221 97-0  
[info@alko-tech.com](mailto:info@alko-tech.com)  
[www.alko-tech.com](http://www.alko-tech.com)

### **AL-KO Technology Austria GmbH**

Talstraße 150  
6284 Ramsau im Zillertal  
Austria  
Tel. +43 5282 3360 700  
[vertrieb.at@alko-tech.com](mailto:vertrieb.at@alko-tech.com)  
[www.alko-tech.com](http://www.alko-tech.com)



Visit AL-KO at  
[facebook.com/alko.caravanning](https://facebook.com/alko.caravanning)

Part No. 499 621 – Subject to changes in line with technical progress.  
No liability accepted for mistakes and printing errors. Version 08/2018